

SAE Type "J"

Murray KEYSTONE® pinch clamps offer superior strength.

KEYSTONE clamps are available in 300 series stainless steel.

How to Determine Proper Clamp Size

Measure actual O.D. of hose on fitting, or overall O.D. of items to be clamped together. Select a clamp size whose clamping range includes this O.D.

KEYSTONE Pinch Clamps have a welded construction, are quick and easy to install, and provide a uniform, tamper proof seal. Keystone Pinch Clamps are widely used on both soft hose and rigid plastic pipe. You will find these clamps anywhere you connect poly pipe. Keystone Pinch Clamps are excellent for use in a multitude of irrigation and water supply systems; on fuel and vapor lines; to attach dust shields and air filters; for beverage supply lines; for car wash supply lines; and for securing bundles of cable.

- When crimping with a hand tool, Murray's true Keystone geometry, located in the ear area, dramatically reduces miscrimps.



HAND INSTALLATION
TOOL A2000

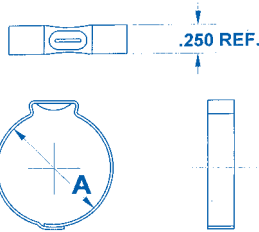

Materials

KEYSTONE® Pinch clamps are available in 300 Series stainless. KS3—300 Series Stainless

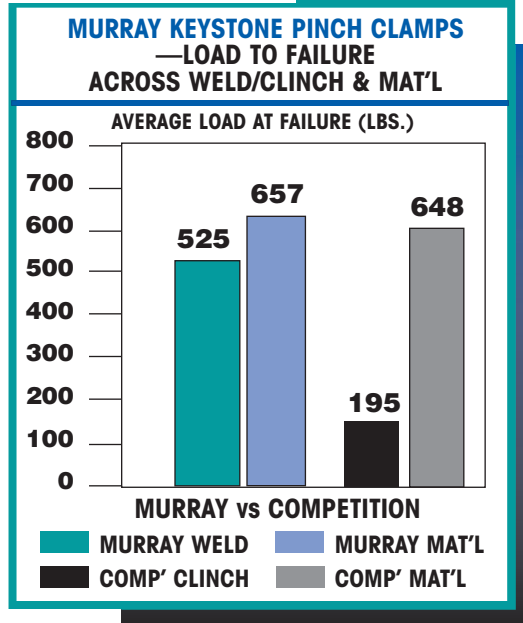

Part Number	"A" Range			
	Metric		Decimals	
	Open	Closed	Open	Closed
KS3101	10.1	8.5	.400	.335
KS3108	10.8	9.1	.425	.360
KS3113	11.3	9.7	.445	.380
KS3119	11.9	10.0	.470	.395
KS3128	12.8	10.9	.505	.430
KS3133	13.3	11.4	.525	.450
KS3140	14.0	12.1	.550	.475
KS3150	15.0	12.5	.590	.490
KS3157	15.7	13.2	.620	.520
KS3161	16.1	13.6	.635	.535
KS3165	16.5	14.0	.650	.550
KS3173	17.3	14.7	.680	.580
KS3178	17.8	15.2	.700	.600
KS3185	18.5	16.0	.730	.630
KS3190	19.0	16.5	.750	.650
KS3198*	19.8	16.6	.780	.655
KS3210*	21.0	17.9	.830	.705
KS3222	22.2	19.1	.875	.750
KS3236	23.6	20.5	.930	.805
KS3248	24.8	21.7	.975	.855
KS3256*	25.6	22.5	1.010	.885
KS3260	26.0	22.9	1.025	.900
KS3271*	27.1	24.0	1.070	.945
KS3286	28.6	25.5	1.125	1.005
KS3301	30.1	27.0	1.185	1.060
KS3316*	31.6	28.5	1.245	1.120
KS3324	32.4	29.3	1.275	1.155
KS3331*	33.1	30.0	1.300	1.180
KS3346*	34.6	31.5	1.360	1.240
KS3364	36.4	33.3	1.435	1.310
KS3396	39.6	36.5	1.560	1.440
KS3410*	41.0	37.9	1.615	1.490
KS3425*	42.5	39.4	1.675	1.550
KS3445	44.5	41.4	1.750	1.630
KS3460	46.0	42.9	1.810	1.690
KS3476	47.6	44.5	1.875	1.750
KS3485*	48.5	45.5	1.910	1.787
KS3508	50.8	47.7	2.000	1.880

SIZE	PIECES/BAG	PIECES/MASTER CARTON
KS3198	10	1000
KS3198	100	2500
KS3210	10	1000
KS3210	100	2500
KS3256	10	1000
KS3256	100	2500
KS3271	10	1000
KS3271	100	2500
KS3316	10	1000
KS3316	100	2500
KS3331	10	1000
KS3331	100	2500
KS3346	100	2500
KS3410	100	2000
KS3425	100	2000
KS3485	100	2000

KEYSTONE PINCH CLAMP PACKAGING

All sizes are available bulk packaged in corrugated cartons. Keystone Pinch clamps for irrigation applications are packaged standard in poly bags, in the following counts:

All sizes are available bulk packaged in corrugated cartons.

*Popular Irrigation sizes are available for immediate shipment packaged in poly bags. Please inquire on availability of other packaging configurations and lead time for other sizes. Other sizes, shapes and materials are available upon request, subject to minimum order quantities.